

ALBATROS

Lifting Bolt for Parasol Installation with a Crane

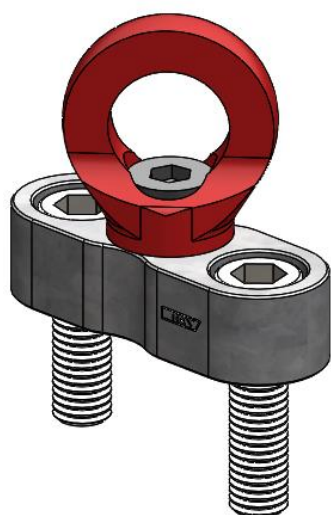

Lifting bolt
Art. no.: 360538

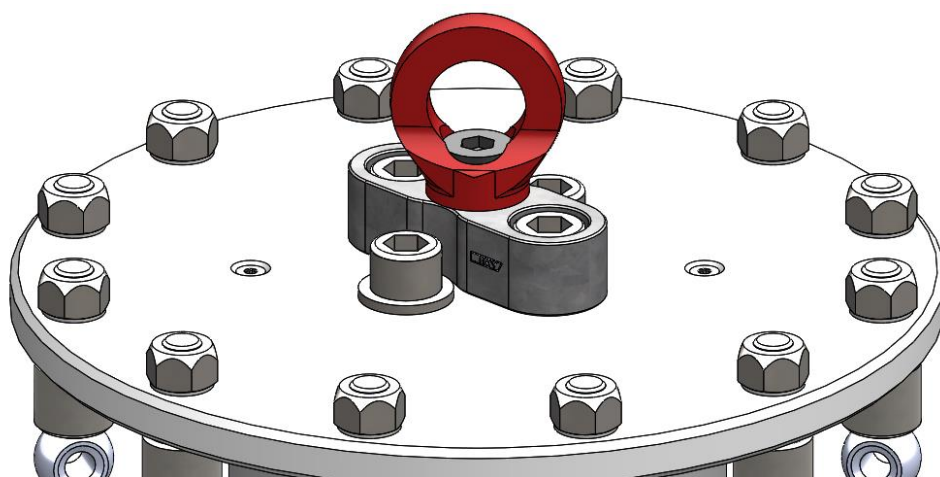

Lifting bolt screwed on

These instructions describe how to safely attach and remove the lifting bolt on the ALBATROS for parasol installation with a crane.

To set up an ALBATROS correctly, follow the current "ALBATROS Installation instructions" in full.

Attach lifting bolt

Follow the current "ALBATROS Installation instructions," chapter "Assembly: Unpacking the parasol," up to and including step 5. Do not insert the parasol into the anchor foot upper part yet. Then perform the following assembly steps:

1. Unscrew the top cap counterclockwise.

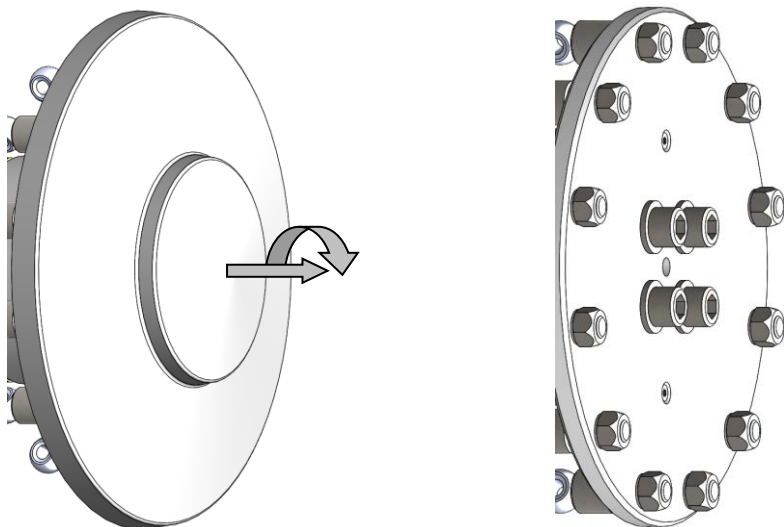

2. Loosen two diagonally opposite hex socket head screws and remove them. Use a 10 mm hex key. The screws are bonded. Loosen them with controlled, even taps on the inserted hex key.

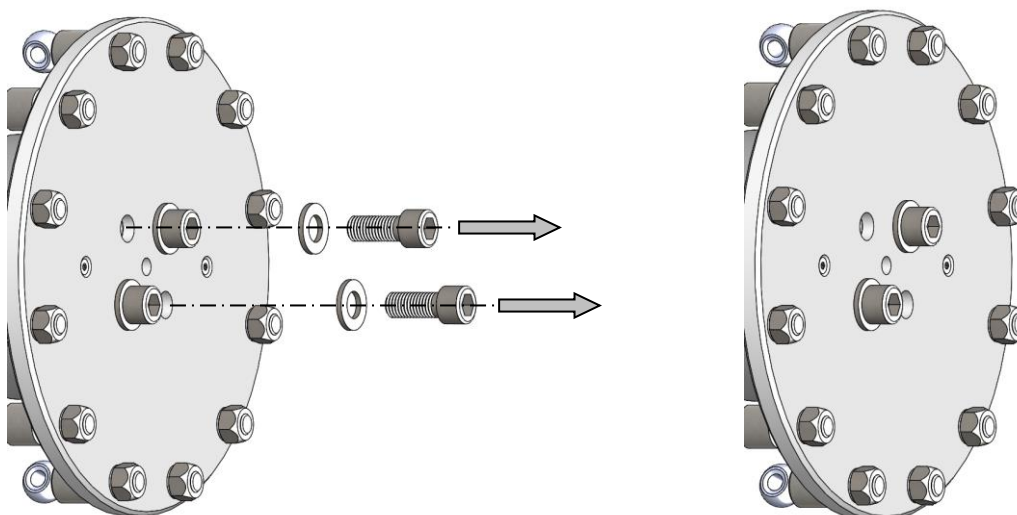

3. Check the pre-assembly. If the lifting bolt is not preassembled, assemble the parts as shown. Make sure the Stairville eyebolt sits flush on the adapter at the top.

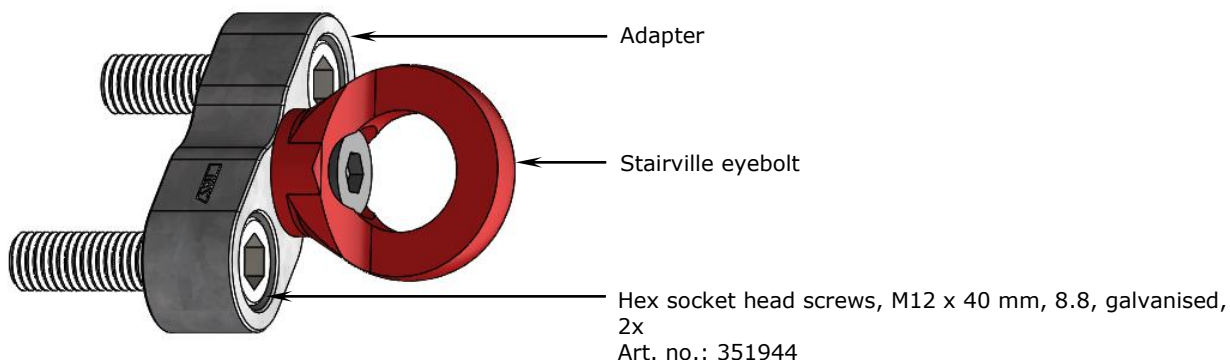

4. Screw the lifting bolt flush onto the hub plate. Use a 10 mm hex key. Then tighten the hex socket head screws to 86 Nm with a torque wrench.

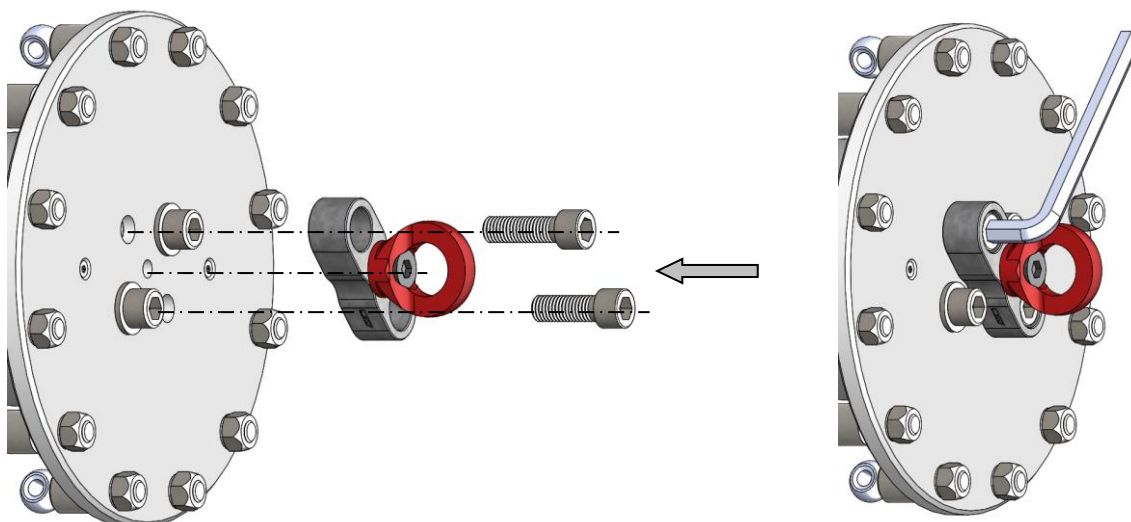

Caution

Material damage due to incorrect torque.

Tighten the specified screws to 86 Nm. Use a torque wrench.

5. Check the Stairville eyebolt. Verify that the eyebolt shoulder sits flush and that the Stairville eyebolt can rotate freely through 360°. Use the loose bail in the center to tighten. Then fold the bail away so the eyebolt can rotate freely.

6. Attach the parasol to the crane using the Stairville eyebolt.

Use only lifting accessories rated for approx. 500 kg and undamaged. The crane operator must comply with all statutory requirements. Here are some key points:



Warning

Hazard from improper lifting aids.

Only use lifting aids that are rated for the specified weight and are free from damage. The use of damaged or unsuitable lifting aids can lead to serious injury or damage.



Caution

Hazard from inadequate load securing.

Ensure that the lifting accessories are correctly selected for the weight and type of load and are undamaged to prevent the load from falling or slipping.



Warning

Load swinging during transport.

During transport, all potential risks, such as the swinging of the load or walking under suspended loads, must be avoided. People can suffer serious injuries from swinging loads.



Warning

Hazard of collision with the load.

Avoid being in areas where there is a risk of being struck by the suspended load. People can sustain serious injuries from collisions with the load.

Remove the lifting bolt

1. After completing the parasol installation, unscrew the lifting bolt. Use a ladder. Never lean the ladder against the canopy (risk of damage; holes and abrasions are not a warranty case).

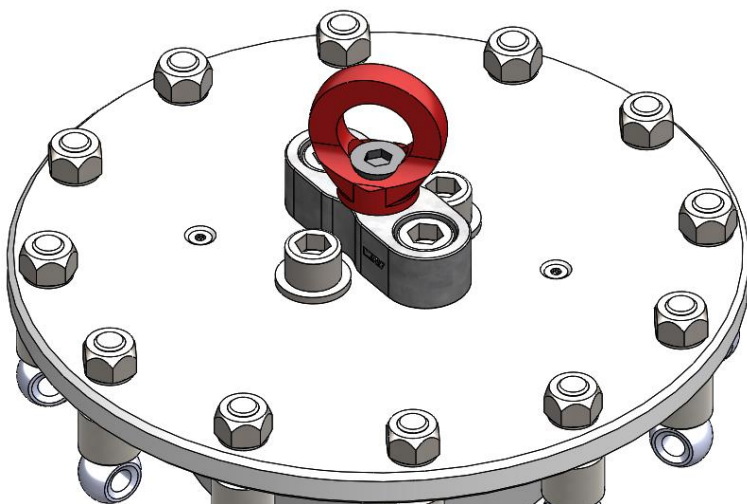

Danger

Fall hazard when working on a ladder.

Improper ladder use can cause injury and property damage.

- Use a self-supporting step (A-frame) ladder.
- Make sure the ladder is in good condition.
- Set the ladder straight and stable on firm ground.
- Follow the manufacturer's instructions.

2. Loosen the two hex socket head screws with a 10 mm hex key.

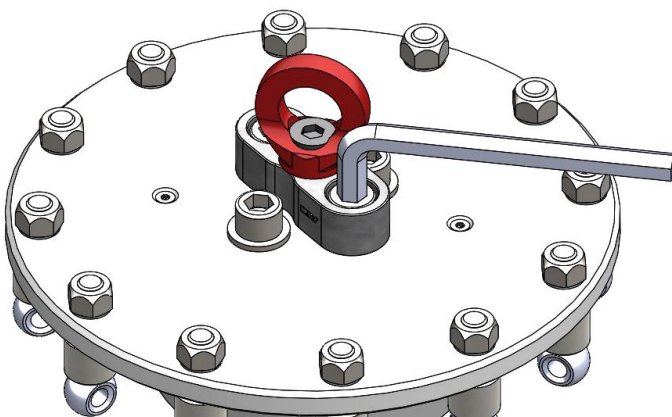

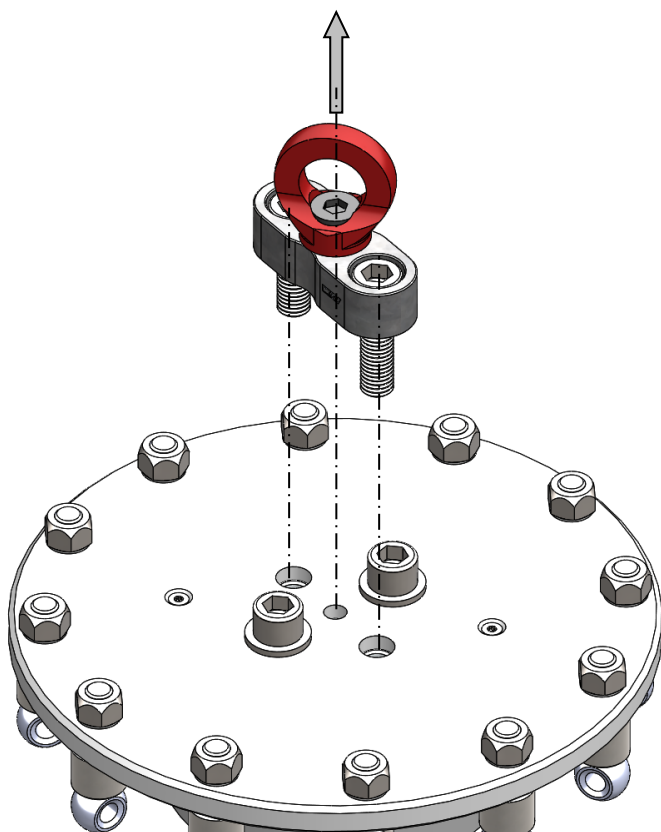

3. Place the two washers over the holes.

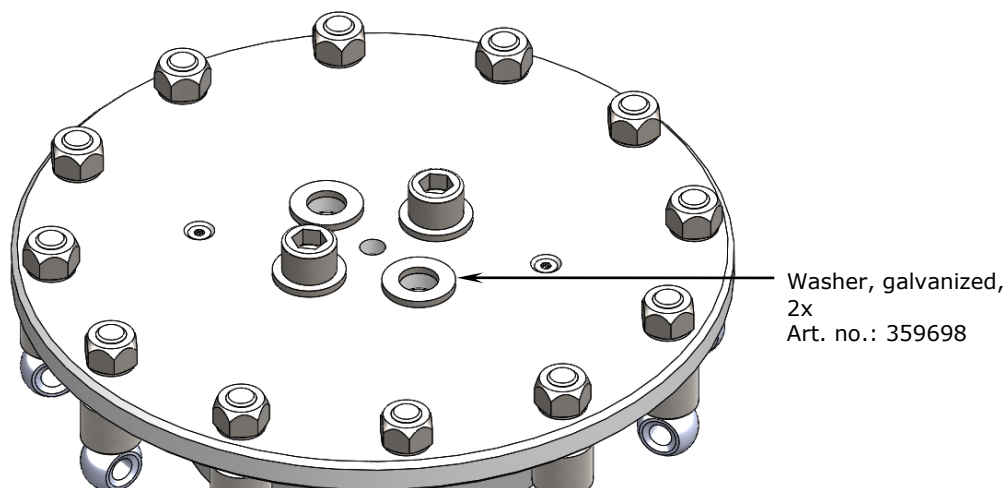

4. Secure the two M12 × 30 mm hex socket head screws by applying about three drops of high-strength threadlocker to the first threads.

5. Insert the two M12 × 30 hex socket head screws into the holes and tighten them with a torque wrench to 86 Nm.

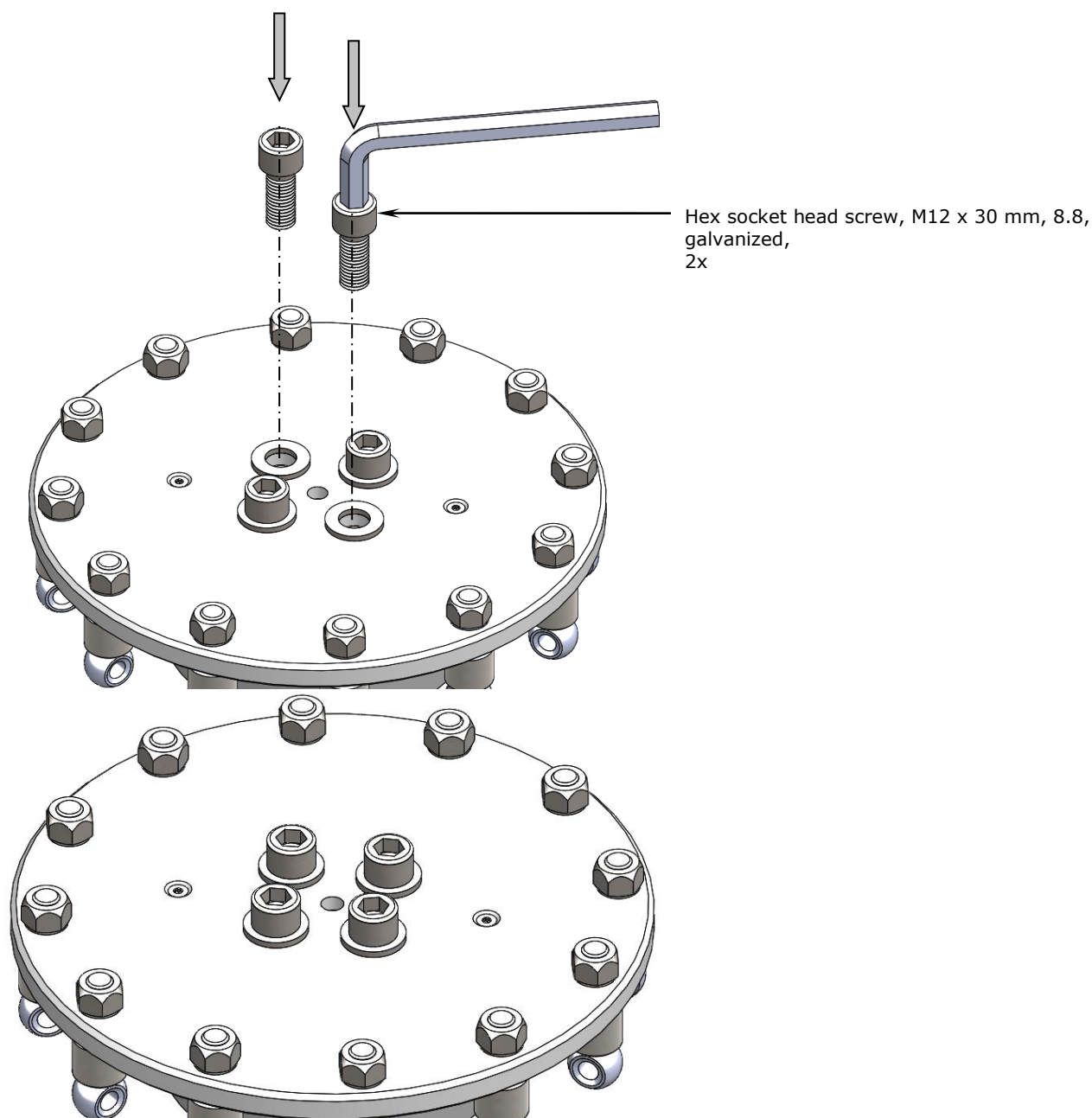

Caution

Material damage due to incorrect torque.

Tighten the specified screws to 86 Nm. Use a torque wrench.

6. Screw the top cap back on. Tighten it hand-tight.

